

ROUTE 1

GROUND FLOOR (RUSSIAN FLOOR 1)

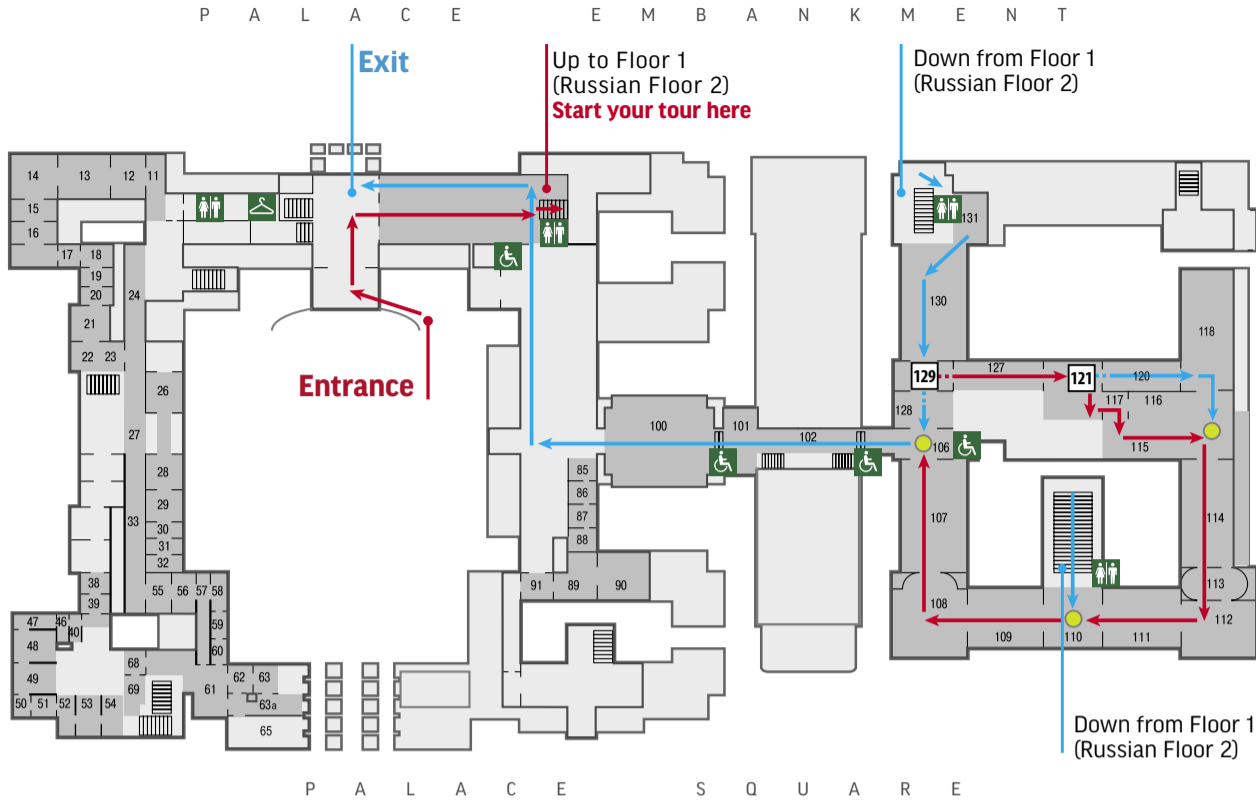

NUMBERS INDICATE THE ROOMS WHERE YOU CAN CHOOSE BETWEEN THE ROUTES.

COLOURED ARROWS INDICATE ROUTE DIRECTIONS.

- 193**
 - ▶ THE SUITE OF STATE ROOMS
 - ▶ THE MINISTERIAL CORRIDOR • RUSSIAN ICONS
- 200**
 - ▶ RUSSIAN ICONS • THE PAVILION HALL
 - ▶ THE PAVILION HALL
- 206**
 - ▶ THE PICTURE GALLERY
 - ▶ DOWN TO GROUND FLOOR (RUSSIAN FLOOR 1)
 - ▶ THE ART OF CLASSICAL ANTIQUITY • ANCIENT EGYPT • EXIT

- 207**
 - ▶ LEONARDO DA VINCI
 - ▶ TITIAN

FLOOR 1 (RUSSIAN FLOOR 2)

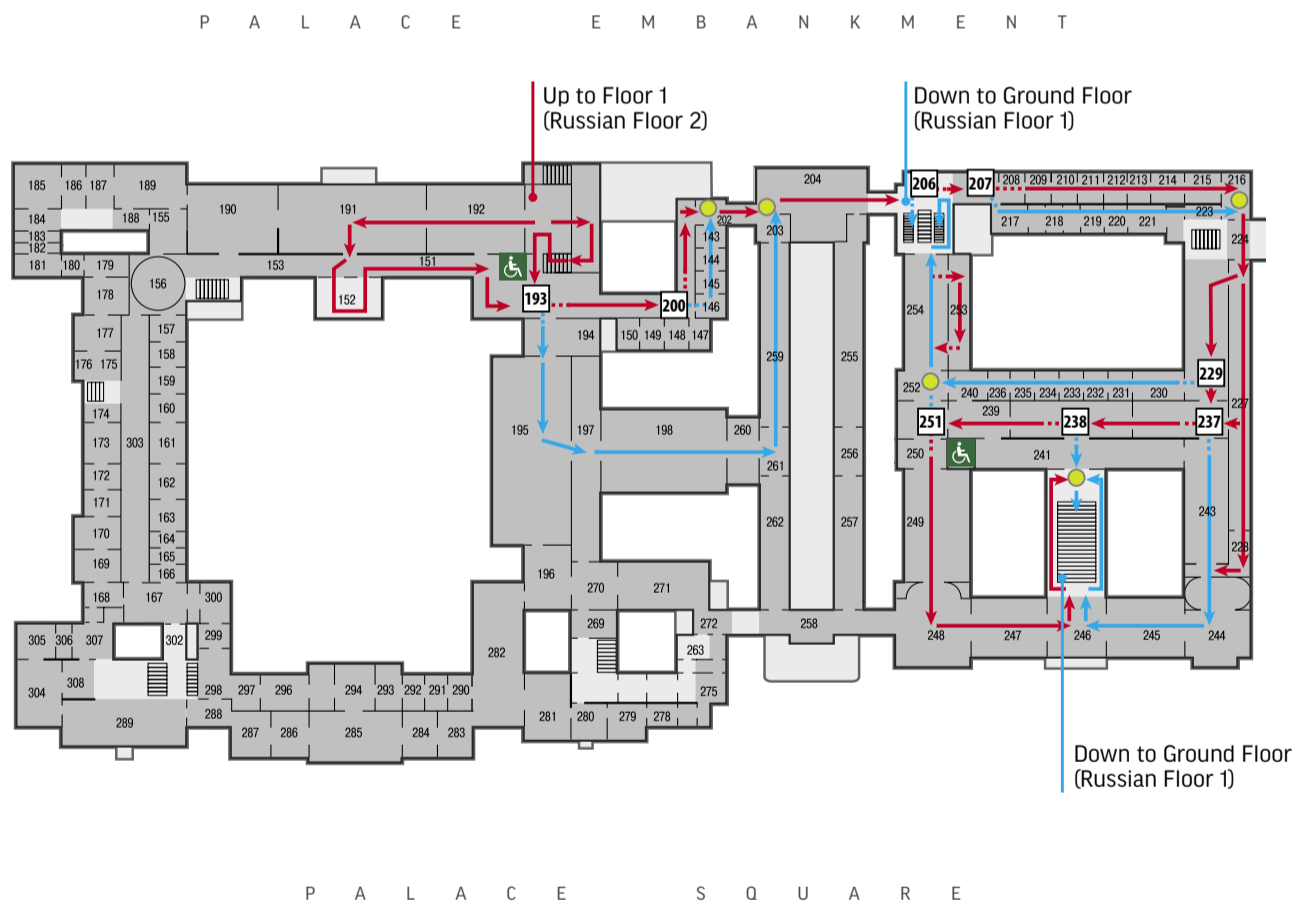

- 229**
 - ▶ THE KNIGHTS' HALL • ITALIAN ART • SPANISH ART
 - ▶ MICHELANGELO • ITALIAN ART • REMBRANDT

- 237**
 - ▶ THE KNIGHTS' HALL • SNYDERS • DOWN TO GROUND FLOOR (RUSSIAN FLOOR 1)
 - ▶ THE ART OF CLASSICAL ANTIQUITY • ANCIENT EGYPT • EXIT
 - ▶ ITALIAN ART • SPANISH ART • REMBRANDT • RUBENS

- 238**
 - ▶ SPANISH ART • REMBRANDT • RUBENS
 - ▶ DOWN TO GROUND FLOOR (RUSSIAN FLOOR 1)
 - ▶ THE ART OF CLASSICAL ANTIQUITY • ANCIENT EGYPT • EXIT

- 251**
 - ▶ DUTCH PAINTING • RUBENS • VAN DYCK
 - ▶ REMBRANDT • THE ART OF CLASSICAL ANTIQUITY • ANCIENT EGYPT • EXIT

- 129**
 - ▶ THE ART OF CLASSICAL ANTIQUITY • ANCIENT EGYPT • EXIT
 - ▶ ANCIENT EGYPT • EXIT

- 121**
 - ▶ THE HALL OF CARVED STONES • THE HALL OF VASES
 - ▶ THE ANTIQUITIES OF THE NORTHERN BLACK SEA AREA, FROM THE SEVENTH CENTURY BC TO THE THIRD CENTURY AD

000 NUMBER OF THE ROOM WHERE YOU CAN CHOOSE BETWEEN THE ROUTES

▶ ROUTE DIRECTION

● ROUTE CONNECTION POINT

DISABLED ACCESS

TOILETS

CLOAKROOM